

TradeDot

Wholesaler for wall System Solutions

One Stop Shop,
A New Era Of
Intelligent
Services.







Contents

- **Introduction**
 - **Mission & Vission**
 - **Services & Products**
ORS ,
ORG
 - **Drywall systems**
- 

Introduction

Playing the role of complete system solution provider for Healthcare Wall Systems, emphasizing the gained benefits in behind of using one supplier to maintain the Design, Supply Chain and Operation requirements of each project, implementing the necessary fundamentals of making the decisions through projects' stakeholders.

TradeDot is a limited liability company, established in 2020 according to the investment Egyptian Law (GAFI).

TradeDot is a trading company targeting the under-construction healthcare projects in both directions of niche and commodity market, by supplying a complete wall systems solutions for the critical and normal function areas.

TradeDot is playing the roe of the local producer company that deeply targets to apply the international technology of producing the Operations Rooms through the local available products, pushing the production benefit for the Egyptian economics.

who we are

We are a local manufacture for custom-made wall systems, targeting to achieve the maximum engineering performance of the sound and thermal insulations, fire protection, anti impact, anti bacterial & fungus, self hygienic performance, anti radiation & anti vibration, which are totally subjected for healthcare sector needs.

Giving the best solution of the current local and abroad manufacturers, based on the financial performance (initial – running – maintenance – depreciation) executing and customizing a fit technical and financial solution to meet the customers' needs.



Mission

OUR DUTIES



VALUE ENGINEERING & QUALITY NEVER
GOES OUT OF STYLE

Value's

The right mix of trusted specialists, crystal- clear communication and team alignment on project goals.

We devote the proper time and attention to assembling project teams tailored to each healthcare customer's individual needs



**Merging between the Technologies of the
Lightweight Construction Solutions and
Healthcare Solutions.**

OUR AMBITION

Coping with the economic development of the Egyptian construction market especially in healthcare sector, using the available competences in the market to build a brand and role model for OneKey Hospital Form.



We help the healthcare sector to perform better

Enabling the economic development of the Egyptian Healthcare sector through merging markets of construction & healthcare, to provide intelligent completed solutions that support great investors & patients experience.



Products & Services

Wall and Ceiling System & Flooring

Our Solution for all areas with special hygienic requirements are Local based on the high ranked manufacturers in Egypt

Wall systems

Glass Walls – Stainless steel Walls – PVC

Local St . St wall panel cladding (Pre-fabricated modular operating Room)

Cladding Walls - Anti Bacterial & Fungi Painted Walls

Ceiling system & local Touch Control Panel and Doors

Engineering Services & Design

From inception to reality...

Architectural Design - Medical Equipment planning - Shop drawings

3D Planning - Value Engineering installation Supervision - Application Training - After sales

We equip your OR with our highly flexible Modular Wall System, easy to install, dismantle, interchange and expand, while at the same time offering

Our team is made up of experienced designers, architects and medical planners, as well as project managers. we have experience in both healthcare and construction sectors with over 20 years of experience.

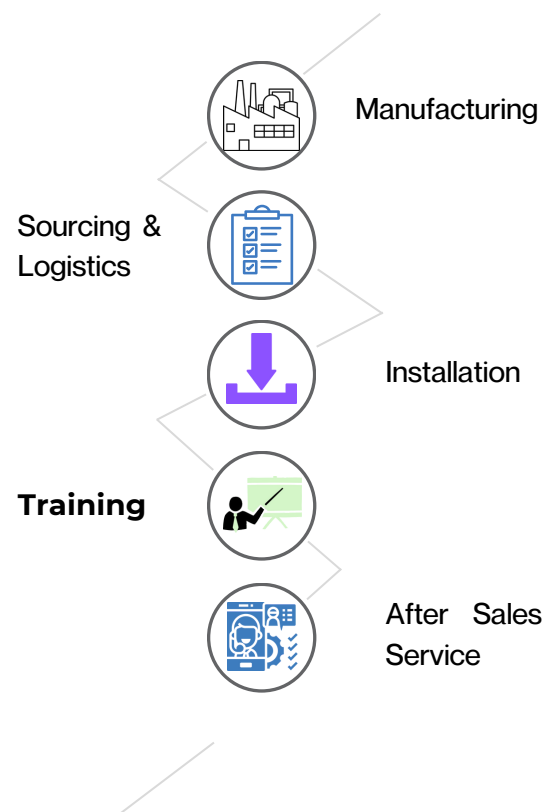

Products & Services

St. St wall panel

Local products and solutions based on the high ranked manufacturers in Egypt manufactured according to EN standard

The surface of metal wall panels is microscopically flat and free of pores, resistant against living organisms and chemical

Wall board produced based on EN 520, 15 mm/12.5mm, possible to having H1/H! moisture resistance

and high-grade fire rates up to 120 minutes (Subject of changing the infrastructure according to the norms and codes)

Dimensions

Panel width 200-1200 mm

Panel height 200-3000 mm

St.st thickness 0.8 mm

Panel thickness 15 mm

Performance

Anti-bacterial coating for stainless steel sheets

Reaction to fire Mineral wool insulation layer acc. to DIN EN 13162

Sound insulation according to DIN EN 13162

For Stainless steel it is a subject of the international law of steel grade 304

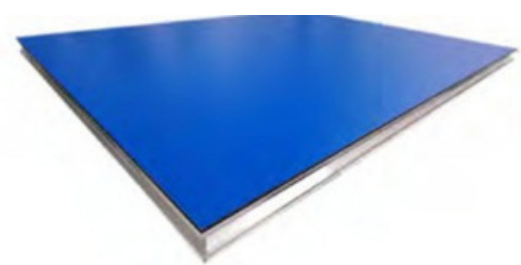
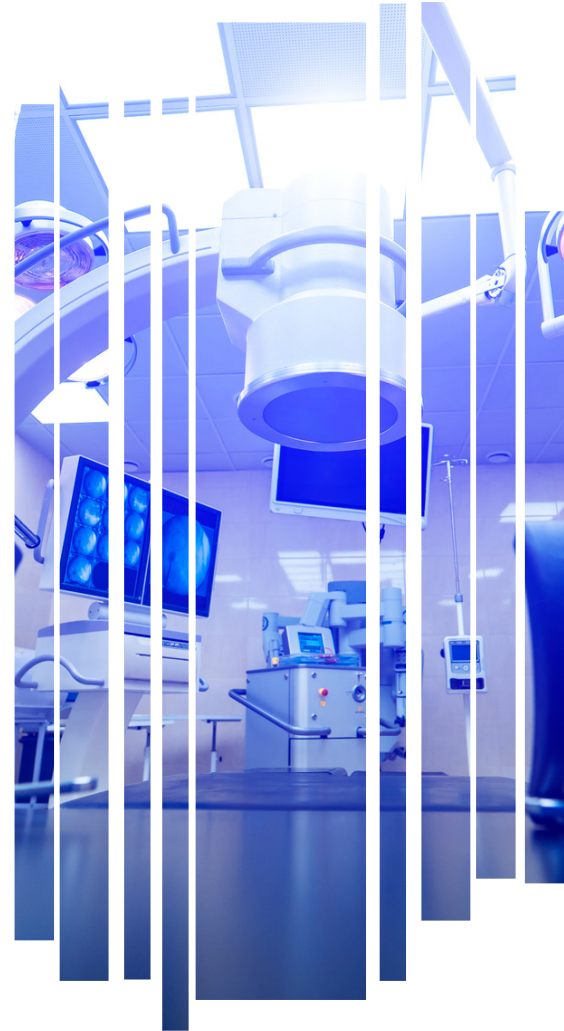

Products & Services

St. St wall panel

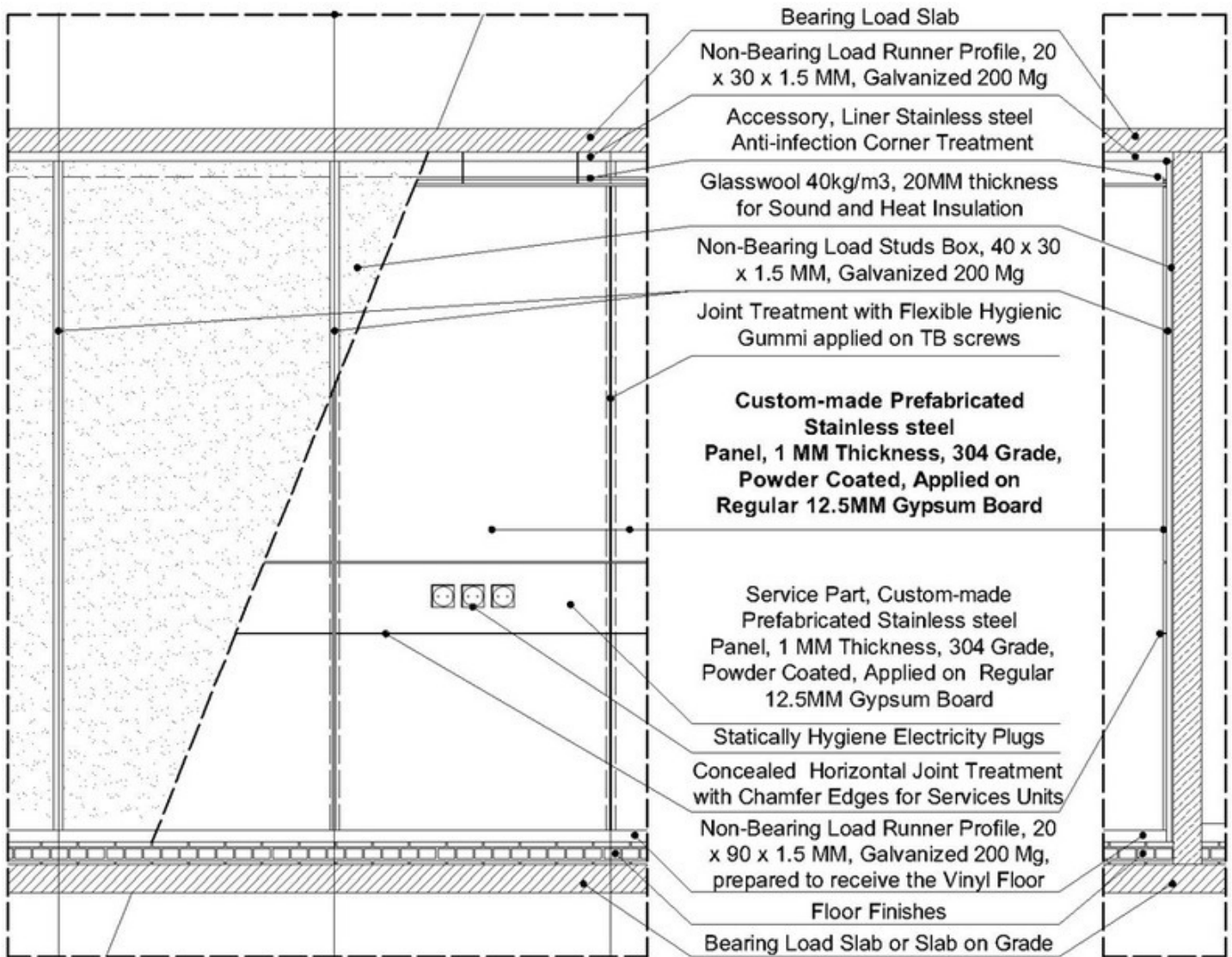

Customize Off-site prefabricated Stainless-steel Walls. For high Sterilized areas in Healthcare sectors, especially for the operations rooms.



OPIKAR is a family-owned company, located in Logatec, Slovenia. Our company has been founded in year 1997 and has around

OPIKAR modular operating room is a self-standing system with no sub-structure for the support of glass.

Glass is integrated into the panel with the al-uminium frame, insulation and sheet metal cover from the backside. There is also a different type of the glass panel which can support the glass on both sides.

Glass is one of the best material to disinfect due to the smooth surface which enables easy cleaning. It is also resistant to all of the disinfectants that are used for cleaning.

- With or without sub-structure
- Own development allowing bespoke developments for specific needs – »custom-made solutions«
- Self-supporting system Ready to mount glass walls with integrated standard equipment
- Pre-fabricated openings for the equipment and appliances
- Modular system which allows to combine different materials inside the operating room
- Easy upgrade and low maintenance costs
- Access to equipment from the corridors or from the operating room

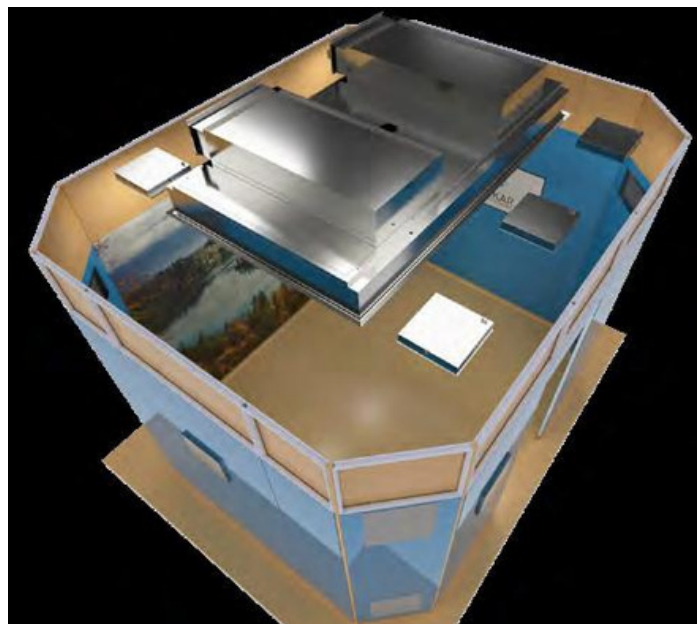



OPIKAR WALL PANEL TYPE SL1

- 40 mm thickness
- Dimensions; width 200-1000 mm, height 200-3000 mm
- CE mark
- 100 Pa tested
- Manufactured according to GMP
- Reaction to fire **A2-s1-d0**, HRN EN 13501-1:2019
- Sound insulation **Rw=31 Db**, HRN EN ISO 717-1:1998
- 6 mm tempered glass SIST EN 12150-2, SIST EN 14179-2
- Glass painted with enamel paint according to RAL chart
- Digital ceramic ink print for motives and high resolution pictures
- Rock wool 33 mm thick insulation, reaction to fire Euroclass A1, EN 13501-1, high density 100kg/m³
- Frame made out of extruded aluminium AW6061 T6 of high strength
- 0,8 mm galvanized steel back plate painted according to RAL chart

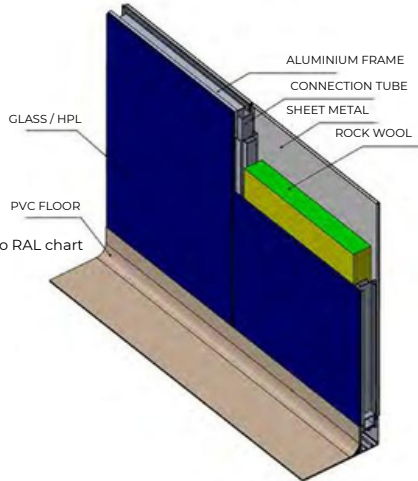

OPIKAR WALL PANEL TYPE SSI

- 40 mm thickness
- Dimensions; width 200-1000 mm, height 200-3000 mm
- CE mark
- 100 Pa tested
- Manufactured according to GMP
- Double 6 mm tempered glass SIST EN 12150-2, SIST EN 14179-2
- Glass painted with enamel paint according to RAL chart
- Digital ceramic ink print for motives and high resolution pictures
- Different colors or motives on each side
- Frame made out of extruded aluminium AW6061 T6 of high strength
- Moisture protection inside the frame
- Vertical reinforcement inside glass panel for width above 600 mm
- Suitable for dividing walls
- Suitable for transparent double glass wall
- Suitable for fully flushed windows inside OPIKAR wall

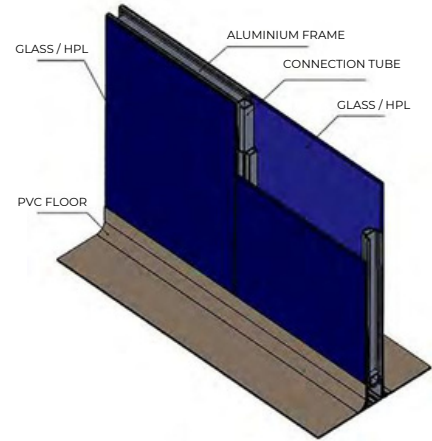

OPIKAR WALL PANEL TYPE S1

- Cladding solution without back plate for reducing cost
- Rw=32 dB; A2-S1-d0**
- Vertical reinforcement inside glass panel for width above 600 mm
- Galvanized steel reinforcements inside glass wall for integrated equipment
- Pre-fabricated openings for the equipment

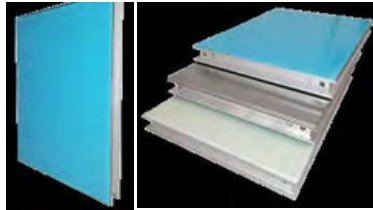

OPIKAR WALL PANEL TYPE HPL1

- 40 mm thickness
- Dimensions; width 200-1000 mm, height 200-3000 mm
- CE mark
- 100 Pa tested
- Manufactured according to GMP
- Reaction to fire **B-s2, d0**
- Sound insulation **Rw=33 dB**, HRN EN ISO 717-1:1998
- 6 mm HPL, EN 438-3
- Rock wool 33 mm thick insulation inside, reaction to fire Euroclass A1, EN 13501-1, high density 100kg/m³
- Frame made out of extruded aluminium AW6061 T6 of high strength
- Cladding solution
- Vertical reinforcement inside glass panel for width above 600 mm
- Galvanized steel reinforcements inside glass wall for integrated equipment
- Pre-fabricated holes for the equipment

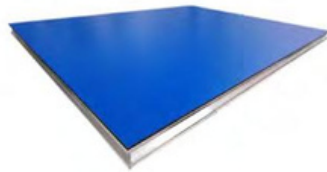

OPIKAR LED WALL PANEL

- 150 mm thickness with LED casing
- Dimensions; 800 x 550 mm (w x h), 1000 x 550 mm (w x h)
- 6 mm tempered glass SIST EN 12150-2, SIST EN 14179-2
- Frame made out of extruded aluminium AW6061 T6 of high strength
- Integrated LED light inside the panel
- Fully flushed



OPIKAR MEDICAL GAS PANEL

- Stainless steel 1 mm AISI 304
- HPL 6 mm, optional
- 1 mm AISI 316, optional
- Dimensions; width 200-1000 mm, height 200 mm
- Suitable for different medical gas sockets
- Fully flushed stainless steel/HPL plate with our wall system
- Without backplate for easier acces
- With or without medical gas socket
- Draeger medical gas sockets, DIN EN ISO 9170-1, DIN 13260-2, optional



OPIKAR ELECTRICAL SOCKET PANEL

- Stainless steel 1 mm AISI 304
- HPL 6 mm
- 1 mm AISI 316 on demand
- Dimensions; width 200-1000 mm, height 200 mm
- Suitable for different electrical sockets
- Fully flushed stainless steel/HPL plate with our wall system
- Without backplate for easier acces
- With or without electrical sockets



Drywall Systems

Partition & Cladding

Partition, 75MM Thick, GKB, DIN standard

- Wall thickness 75 mm
- Stud Cavity (50-75-100) mm
- Cladding thickness (12.5) mm
- Weight (25) kg/m²
- sound reduction index DIN 4109 Rw,R in dB/ 41 to 44 dB
- Insulation nominal thickness 40 to 80 mm
- Thermal insulation 0.40 to 0.66 W/(m²K)
- Fire resistance class according to DIN 4102- 2 F30
- Sound Shield GKF/ GKFI * 12.5 mm

Health Technical Memorandum (HTM), Corner Protection

- Types of protection according to category of damage risk, LD – Light duty/ MD – Medium duty/ HD – Heavy duty/ Severe duty
- BS 5234 includes a separate test for crowd pressure
- in addition to the usual hard body impact tests. This provides useful information on the performance of partitions against the heavy impacts of electric tugs.

Health Technical Memorandum (HTM), Severe and Heavy Duty

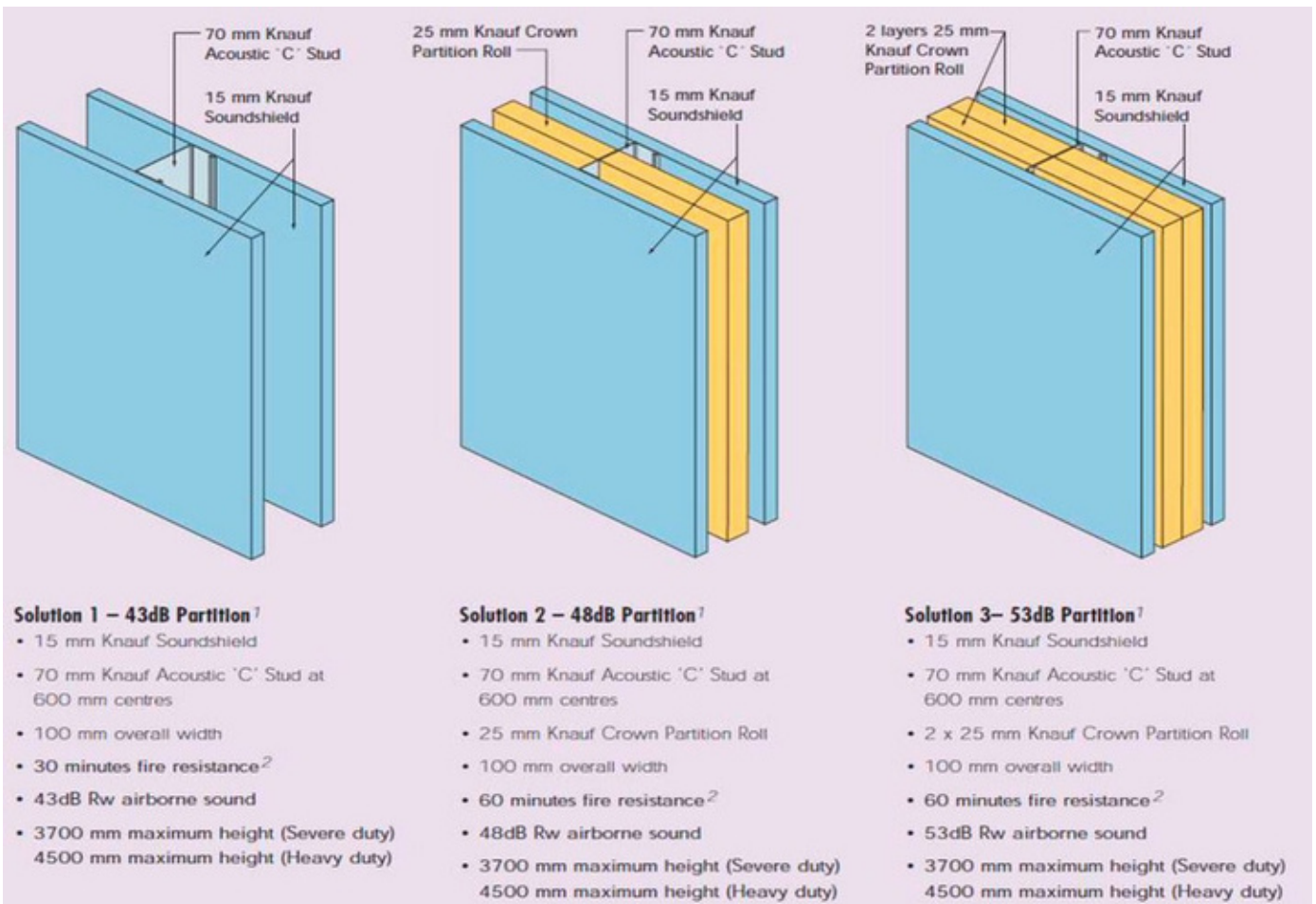

Health Technical Memorandum (HTM), Protected Shaft

Openings in floors for stairways, lifts, escalators, and pipes and ducts, should be enclosed in a protected shaft, which has the same period of fire resistance (integrity, insulation and, where applicable, load-bearing capacity) as the compartment floor.

Protected shafts for stairways and lifts should be provided with protected lobbies, except where they are accessed from a hospital street. Knauf Shaf wall and Firefighting Shaf wall are ideal for lift and service shaft constructions

The use of protected shafts should be restricted to:

- stairways
- lifts
- escalators
- chutes
- ducts
- pipes

Drywall Systems

Partition & Cladding

Health Technical Memorandum (HTM), Fire Hazard Rooms and Areas

HTM 81 identifies fire hazard rooms and areas that should be enclosed in 30 minute fire resisting construction (integrity and insulation). Fire hazard rooms are defined in HTM 81 fire resistance time 30 minutes

Health Technical Memorandum (HTM),

Shaftwalls

Unlimited shaft width with Knauf W629
Lean fire protection with Knauf K251 installation shaft wall with single-layer Fire-board -cladding
High-level noise protection with Knauf W635

Very high wall installations with Knauf W630
fire resistance time 120 minutes

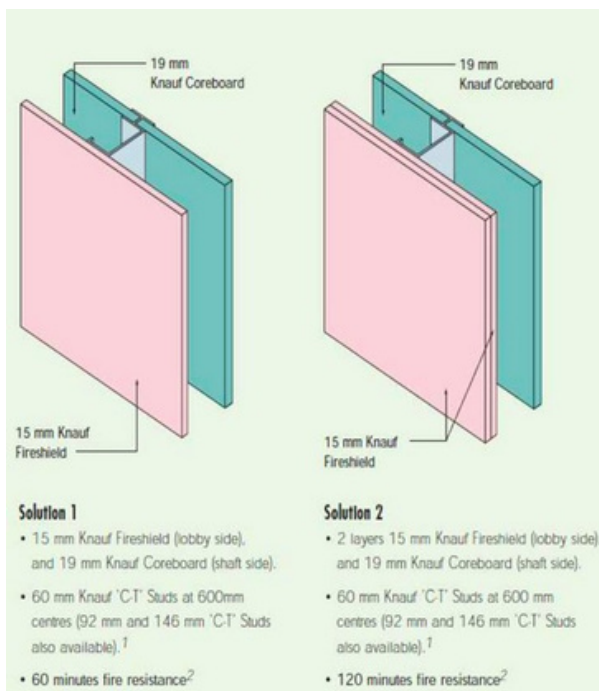

Health Technical Memorandum (HTM), Intensive Therapy Units

To reduce the possibility of smoke entering an ITU department, every door opening in the compartment wall, except those of the hospital street, should be provided with a protected lobby.

Sub-compartment

staff base
bed areas
clean utility
dirty utility
linen store
status laboratory
fire resistance time 60 minutes

Health Wall-insulation board tp 115

Insulation partition wall-insulation board tp 115
Sound protection optimization
High degree of stability and impact resistance through extreme hardness

Health Technical Memorandum (HTM), Ventilation Ductwork

Ventilation ductwork should comply with the requirements of BS 5588: Part 9: 1999: Code of practice for ventilation and air conditioning ductwork, and HTM 2025: Ventilation in healthcare premises.

Ductwork passing through compartment and sub-compartment walls should be provided with fire dampers,
fire resistance time 60 minutes

Health Technical Memorandum (HTM), Conduit/pipework penetration

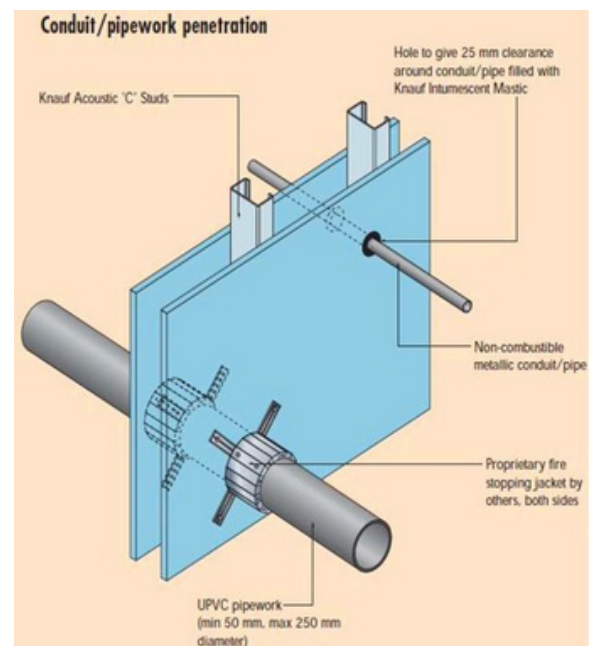

Health Technical Memorandum (HTM), Cable tray penetration with demountable

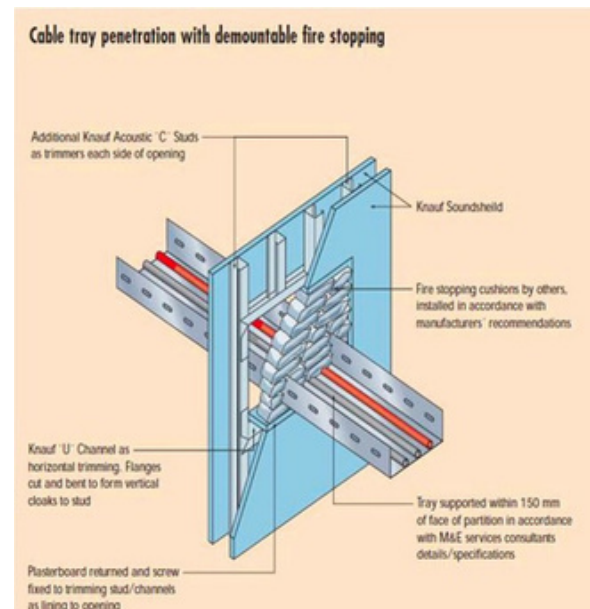



WHOLESALE FOR WALL SYSTEM SOLUTIONS

CONTACT US



CUSTOMER SERVICE

+20224476667



ADDRESS

TradeDot Ltd, 2047 El Nasr
Buildings, El Mearaj city, Maadi,
Ring Road, Cairo, Egypt.



EMAIL

info@tradedot.com.eg



WEBSITE

www.tradedot.com.eg



HOSPITAL